

Setting Up Your GTMC.NET email account on iPad

Here are the basic settings for setting up a [@gtmc.net](mailto:gtmc.net) email account. Not all settings apply to all email programs or mobile devices.

Incoming Mail Server: IMAP or (POP3)

Host Name: mail.gtmc.net

User Name: Entire email address (ex. email@gtmc.net)

Password: Enter your email password

Server Port: 143 or (110)

Use SSL: NO

Outgoing Mail Server:

Host Name: smtp3.gtmc.net

User Name: Entire email address (ex. email@gtmc.net)

Password: Enter your email password

Use SSL: NO

Server Port: 587

Authentication Method: Password

Full Setup Walkthrough

1. Go to your settings.

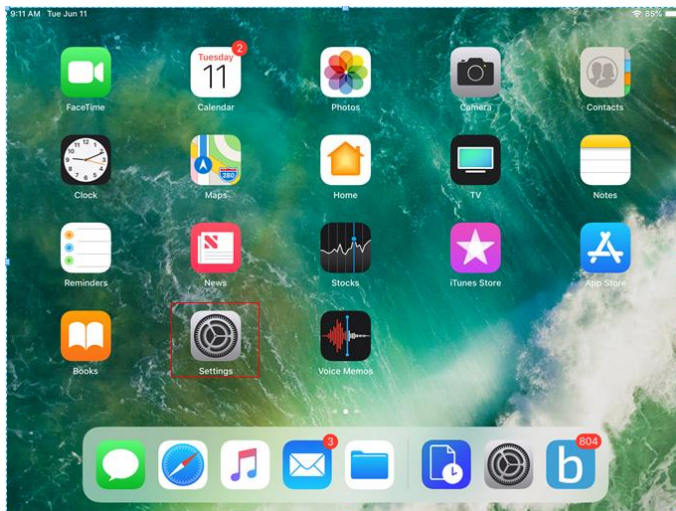

2. Click on the "Passwords and Accounts" tab.

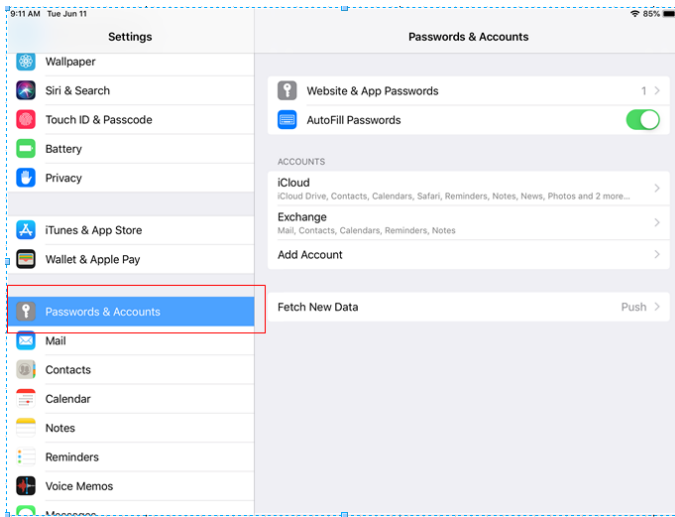

3. Tap the "Add Account" tab.

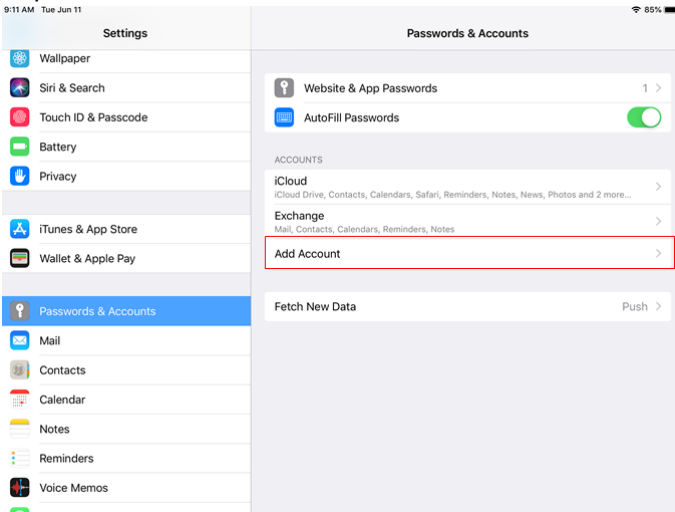

4. Choose the "Other" option.

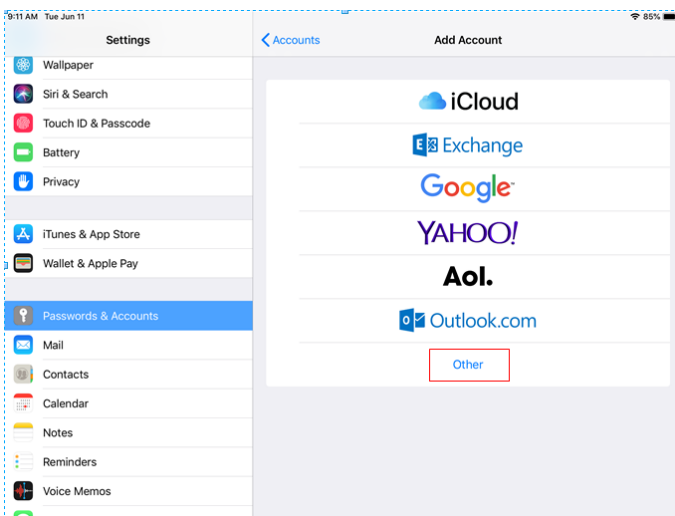

5. Click “Add Mail Account”

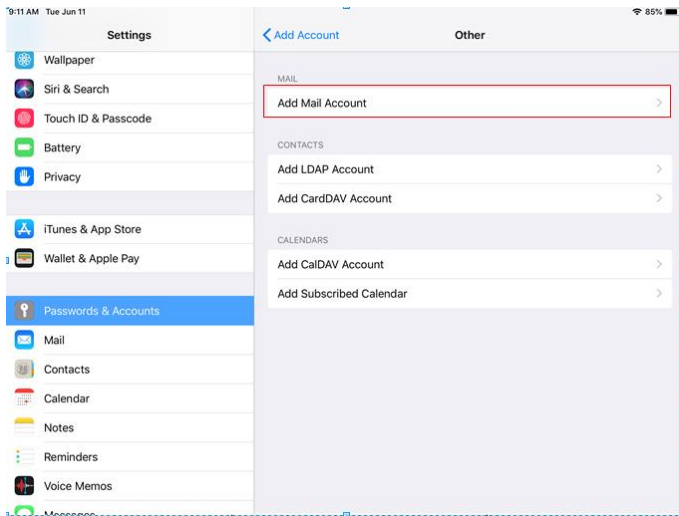

6. Enter your account information as shown below. Enter your Glenwood mail username and password.

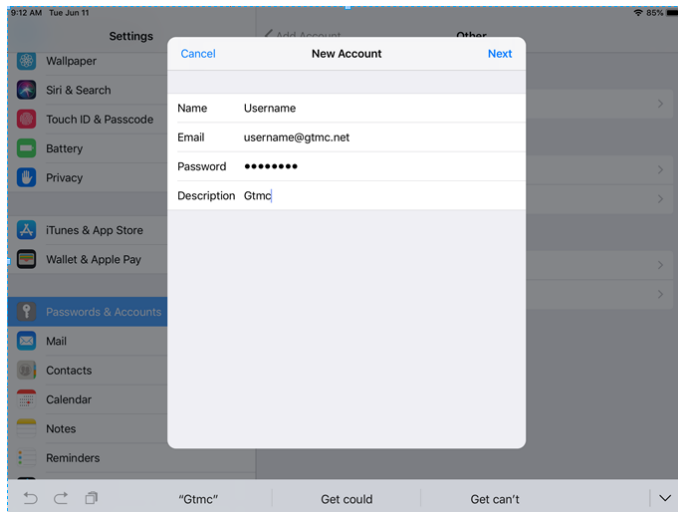

7. Hit "Next". Make sure you have IMAP selected on the top. Enter these settings while using your Glenwood mail username and password.

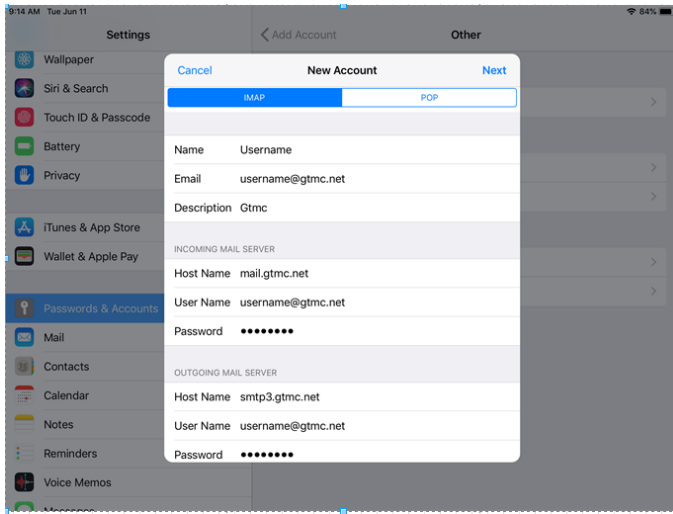

8. Hit the "Advanced" tab to configure the incoming server settings.

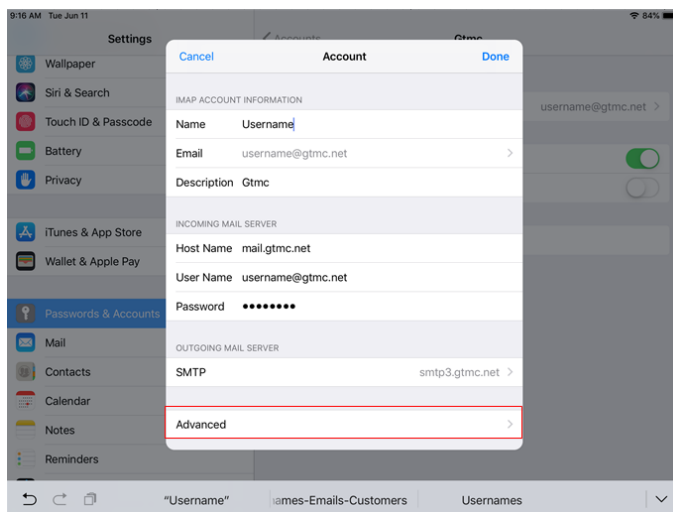

9. Make sure your settings are the same as pictured.

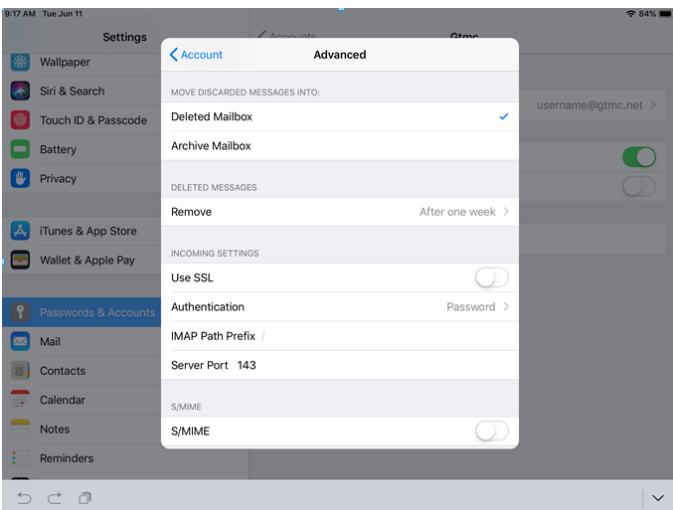

10. Go back to the previous screen and select the SMTP tab to configure the outgoing server settings.

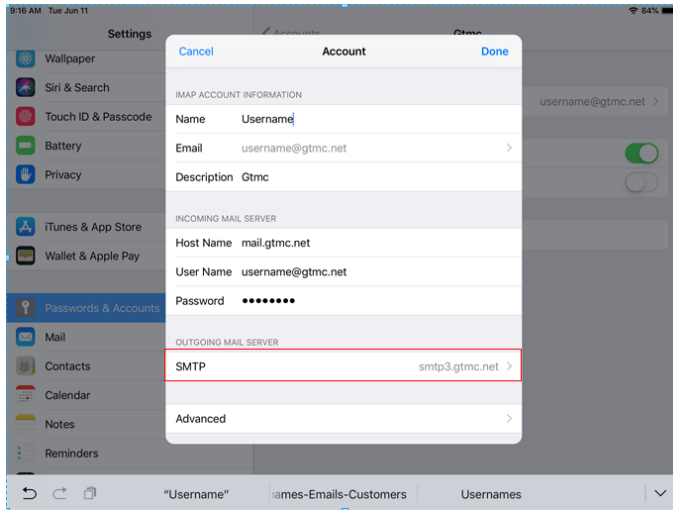

11. Choose the server.

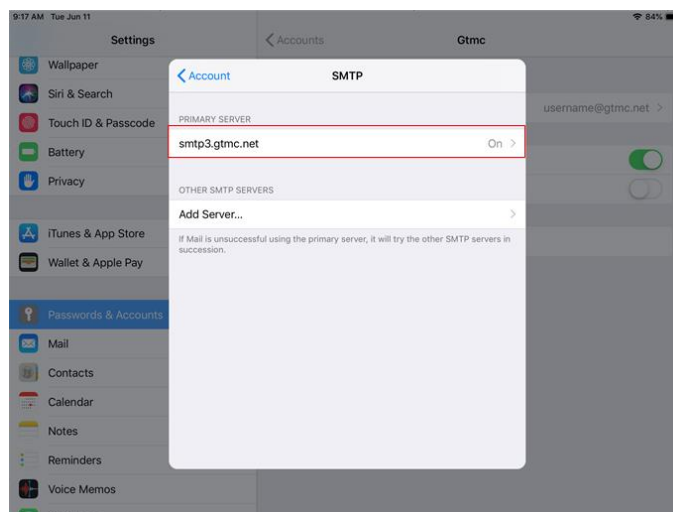

12. Make sure your settings match those of the picture.

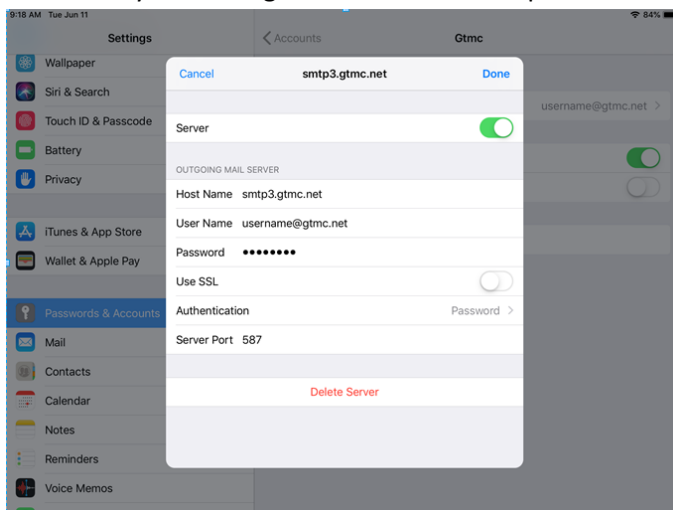

13. Hit "Done". Your account should be set up. If these options do not work, please contact the business office at 402-756-3131.